

# AKIRA

makes life better

---

## Air Conditioner Service Manual



Большая библиотека технической документации

<https://splitsystema48.ru/instrukcii-po-ekspluatacii-kondicionerov.html>

каталоги, инструкции, сервисные мануалы, схемы.

**MODEL:  
AC-S19CGA**

---

## CONTENTS

TECHNICAL SPECIFICATION.....	4
PARTS NAME.....	5
SYSTEM DAIGRAM.....	6
CIRCUIT DIAGRAM.....	8
DISASSEMBLY PROCEDURES.....	9
EXPLODED VIEW AND PARTS LIST.....	18
GUIDE FOR INSTALLATION.....	23
CARE AND MAINTENANCE.....	30
MULFUNCTION ANALYSIS.....	31

## TECHNICAL SPECIFICATION

Model		AC-S19CGA	AC-S19HGA		
Function		Cooling	Cooling	Heating	
Power Supply		1Ph 220-230V / 50Hz			
Capacity (W)		4500	4500	5000	
Rated Input (W)		1800	1800	1900	
Rated Current (A)		8.2	8.2	8.88	
Air Flow (m³/h)		650			
Dehumidifying Volume (L/h)		2.0	2.0	~	
EER (W / W)		2.43	2.43	2.5	
<b>Indoor Unit</b>	Model		AC-S19CGA	AC-S19HGA	
	Motor Fan Speed (rpm)		1250 / 1150 / 1050		
	Output Power (W)		20		
	Fan Type / Piece		Cross Flow Fan – 1		
	Diameter – Length		Φ 91mm – 616		
	Evaporator		Aluminum Fin – Copper Tube		
	Row-Fin Distance (mm)		2 – 1.4		
	Working Area (m²)		0.18		
	Swing Motor		MP 24 GA		
	Input (W)		2		
	Fuse (A)		Controller 3.15A Transformer 0.2A		
	Working Capacitor (μ F)		1		
	Noise (db / (A))		< 44		
	Dimension (w x h x d)(mm)		830 x 285 x 189		
	Net Weight (kg)		11		
<b>Outdoor Unit</b>	Model		AC-S19CGA	AC-S19HGA	
	Input Power (W)		1800	1800 / 1900	
	Current (A)		8.2	8.2 / 8.8	
	LRA (A)		39.8		
	Throtting Method		Capacitor Starting		
	Compressor		SHY33MC4-G		
	Working Temp.		< 115° C		
	Condenser		Aluminum Fin-Copper Tube		
	Pipe-Diameter		9.52		
	Row-Fin Distance (mm)		2 – 1.6		
	Working Area		0.4		
	Fan Motor Power (W) Speed (rpm)		36 / 880		
	Fan Type / Piece		Axial Flow Fan – 1		
	Diameter (mm)		400		
	Defrosting Method		Auto Defrosting		
	Noise (db/ (A))		57		
	Dimension (w x h x d) (mm)		848 x 540 x 320		
	Net Weight (kg)		40		
	Refrigerant Charge		R 22 / 1.3		
<b>Connecting Pipe</b>	Outer Diameter	Liquid (mm)	Φ 6		
		Gas pipe (mm)	Φ 12		
	Max. Diameter	Height (m)	10		
		Length (m)	20		

The technical data are subject to change without notice. Please refer to the nameplate of the unit.

**PARTS NAME**

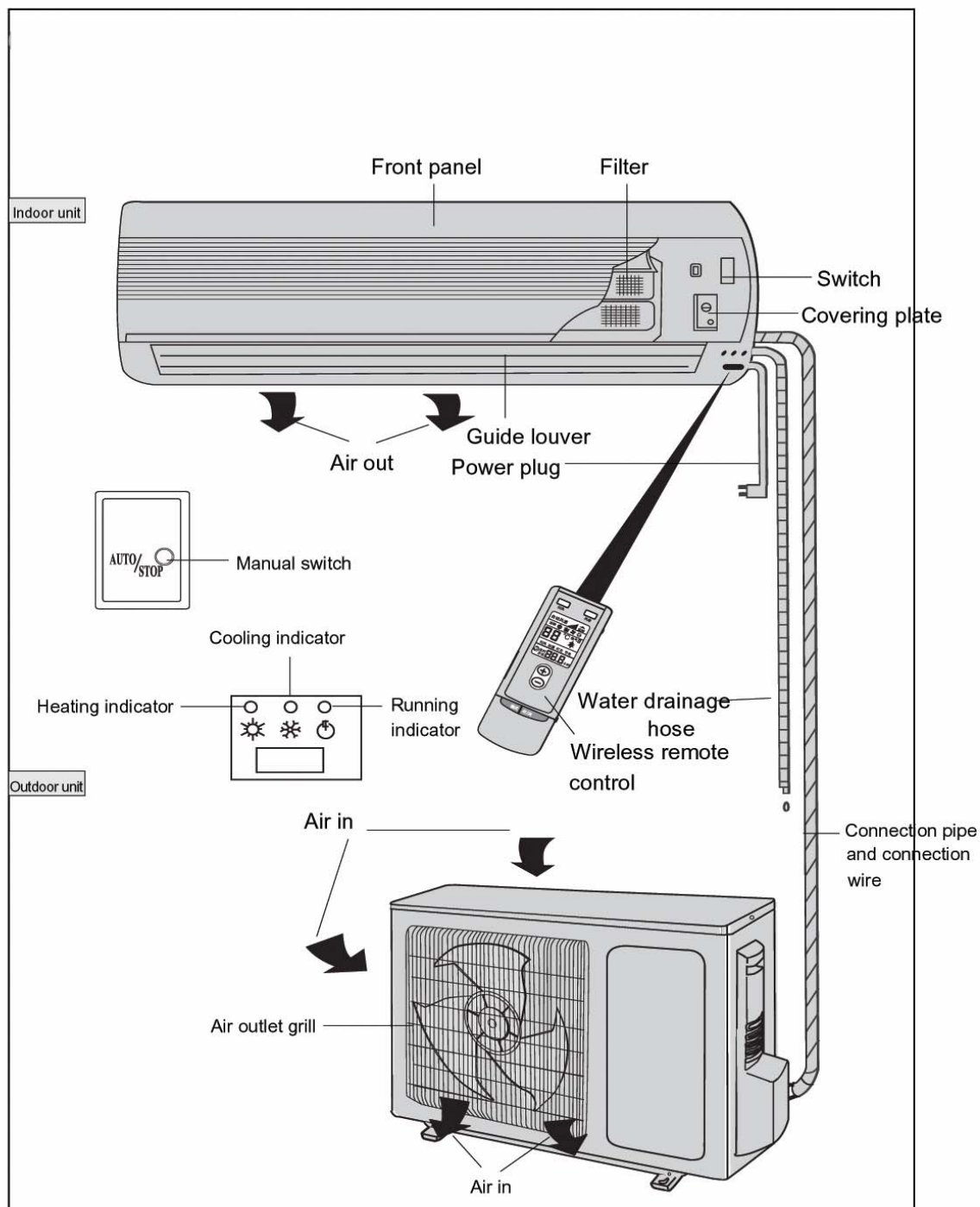

## SYSTEM DIAGRAM

### System diagram for cooling only type

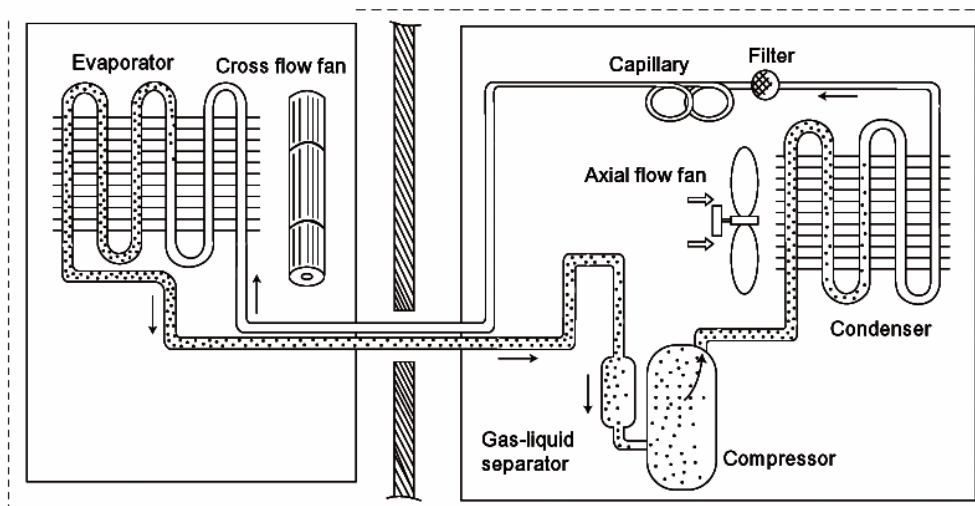

When the power is on, the unit start to work. The compressor sucks low-pressure refrigerant gas from the evaporator and discharges high-temperature and high-pressure gas into condenser. Then air exchanges the heat with outdoor air and becomes refrigerant liquid. The liquid is throttled by the capillary and changes into low-pressure liquid and low-pressure liquid and then flows into indoor evaporator. The liquid exchanges the heat and changes into low-temperature and low-pressure refrigerant gas, the cycle introduced above goes on and on, and the demanded low temperature environment is maintained.

### System diagram for cooling and heating type

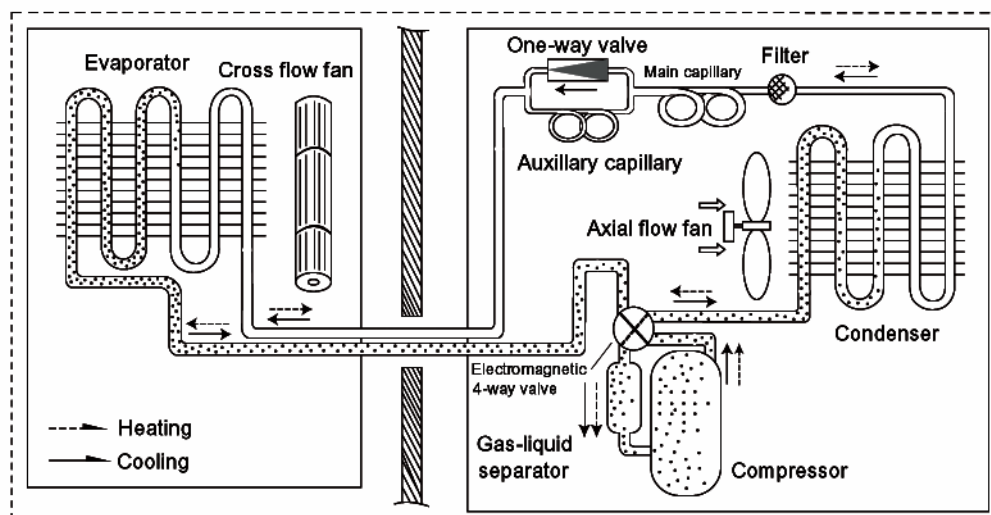

When the power is on, indoor and outdoor units will start to run. When the system operates in cool mode, the compressor sucks low-temperature refrigerant gas from the evaporator and sucked by compressor, compressor into high-temperature, high-pressure Gas, and then discharges into condenser, heat exchanges with the outdoor air becomes into refrigerant liquid, the liquid is throttled by the capillary and the temperature and pressure lower down, enter into the evaporator, heat exchanges with the indoor air which need to be adjusted, then changes into low-temperature, low-pressure refrigerant gas, the cycle introduced above goes on and on, the demanded low temperature environment is maintained. (when in heat mode, the 4way valve changes its way and the refrigerant flows in the reversible cycle, to make the condenser sucks heat, evaporator discharges heat, and the demanded high temperature environment is maintained.

## CIRCUIT DIAGRAM

### Model : AC-S19CGA

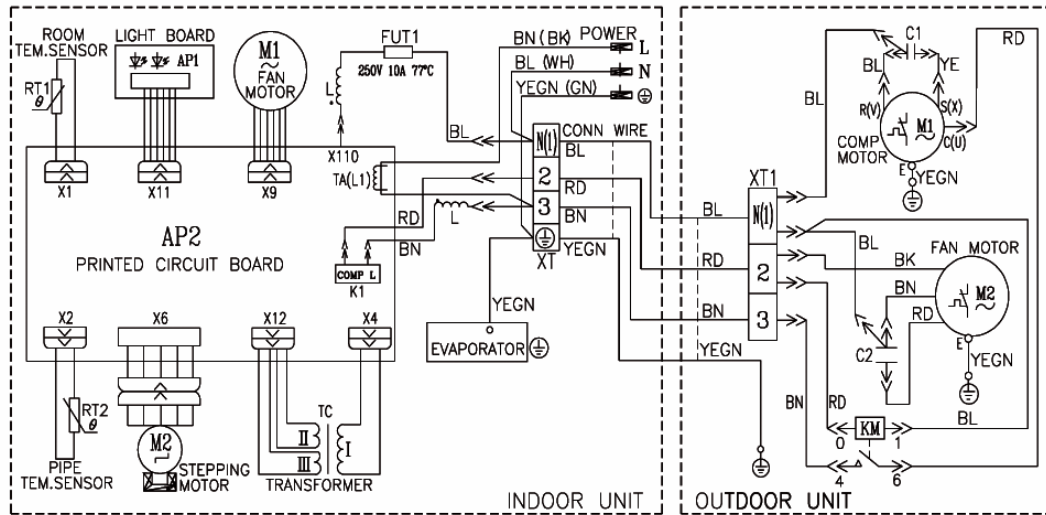

### Model : AC-S19HGA

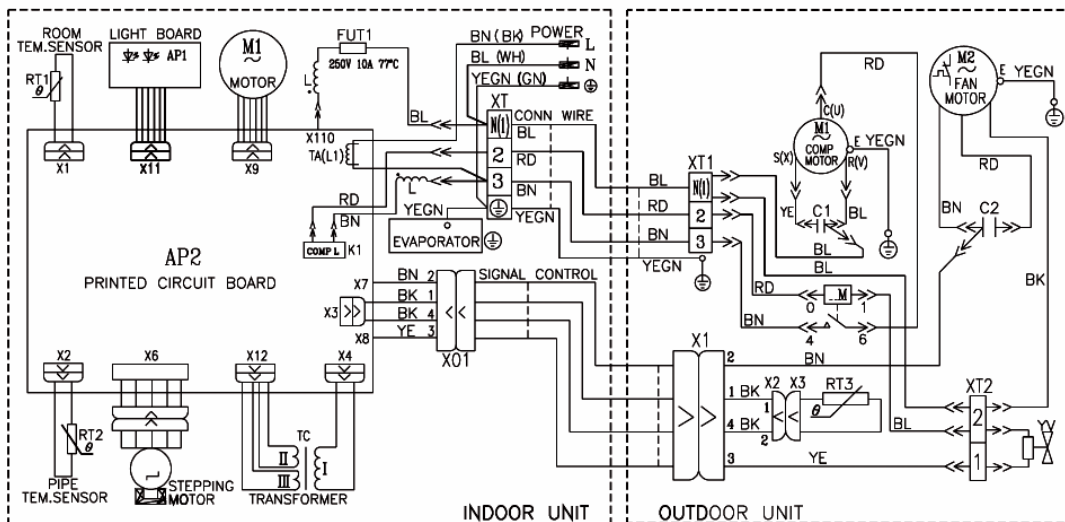



## DISASSEMBLY PROCEDURES

### Operation procedures/pictures

#### Disassemble the front panel

Raise up the front panel, take out the front panel.

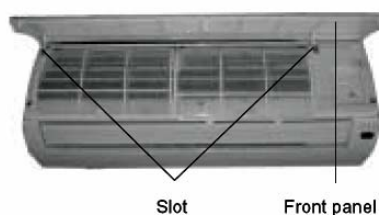

#### Remove filter and wire-pressed clamp

To remove the filter, and screw off 1pc bolt which fixed the wire-pressed clamp to disassemble the wire-pressed clamp.

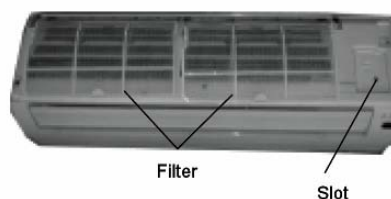

#### Disassemble the guide louver

Disassemble the big guide louver and small guide louver.

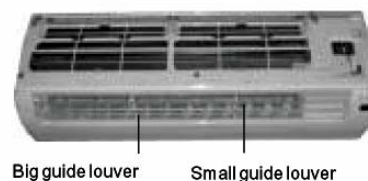

## Operation procedures/pictures

### 3.1.4 Disassemble the front case

To loose the clasp

To remove the screw cap, to loose 3pcs screw, raise it up, disassemble the front case.

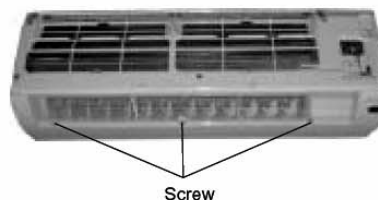
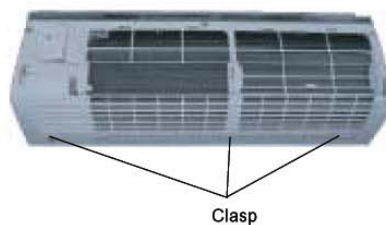

### 3.1.5 Remove the electric box cover

To loose the clasp which fix the electric box, to remove the electric box cover.

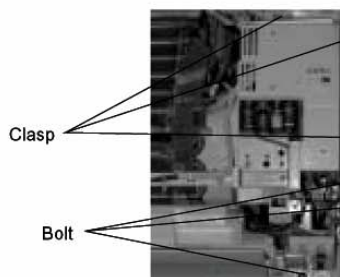

### 3.1.6 Remove the water tray sub-assy

To pull out the terminal of the stepping motor, screw off the bolt to remove the water tray sub-assy. Because of the water drainage pipe, please be careful.

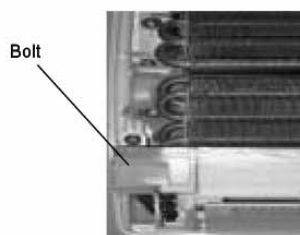

## Operation procedures/pictures

### Disassemble the electric box

Untie the bunch of wire, to loosen the screws on electric box indicator seat, to loosen the earth screw, take out the sensor.

Pull out each terminal, take out the control board.

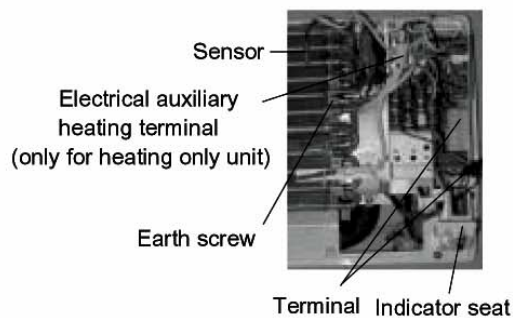

### Disassemble the evaporator

Remove the pipe clamp behind of the rear case. To screw off the bolt of the rear clamp. Then press the clasp forcibly, to pull out the rear clamp.

to screw off two pcs on the left and right side of the evaporator. To press the left nether end of the evaporator, then press it backward, to remove the evaporator side plate clasp from the slot.

Be carefully to take out the evaporator, please take care of the connection pipe.

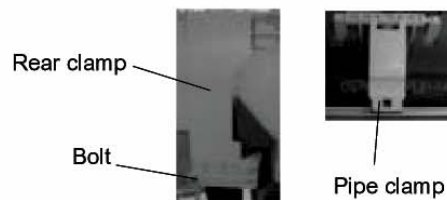

## Operation procedures/pictures

### Remove the motor

Loosen the bolt which fixed the motor clamp, take out the motor clamp.

To loose a fixed bolt which is on the right bearing of cross flow fan, lift up the motor appreciably, then take out the motor.



Bolt

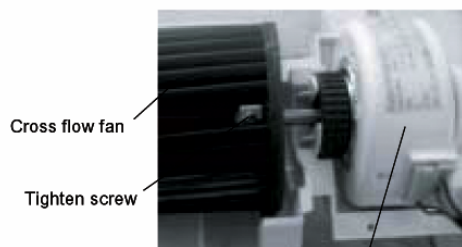

Cross flow fan

Tighten screw

Motor

### Remove the cross flow fan

Loosen one piece of bolt which fixed the cross flow fan, then can take out the cross flow fan.

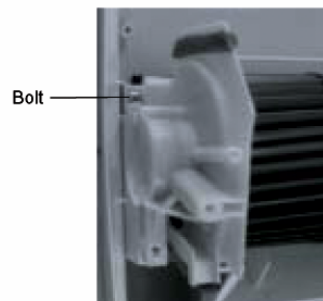

Bolt

## Operation procedures/pictures

### Disassemble the big handle

To screw off the tapping screw which fixed the big handle, could take out the big handle.

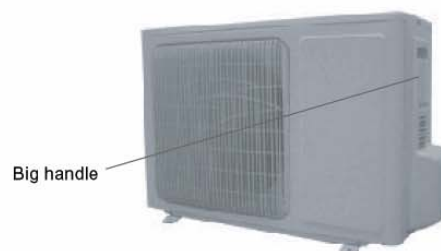

### Disassemble the top cover plate

To screw off 3pcs tapping screw which around the top cover, then lift it up, can take down the top cover.

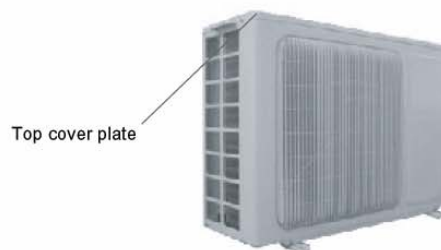

### Disassemble the rear grill

To screw off 4pcs tapping screw of the rear grill, can take off the rear grill.

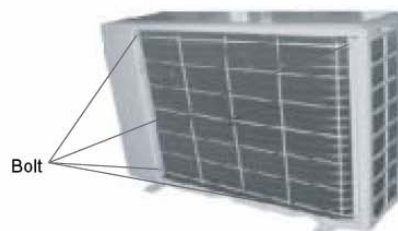

## Operation procedures/pictures

### Disassemble the front panel sub-assy

To screw off 5pcs tapping screws which come from the front panel, valve support, chassis and side plate of the condenser, then can take out the front panel sub-assy.

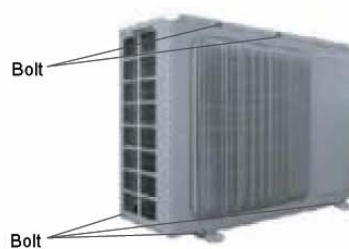

### Remove the electric appliance mounting board

To screw off 1pc bolt which fixed the electric appliance mounting board, take out the leading wire insert from the compressor and fan motor, take out the electric appliance mounting board.



### Disassemble the right side plate

To screw off 7pcs bolt of the rear side plate, then can disassemble the right side plate.

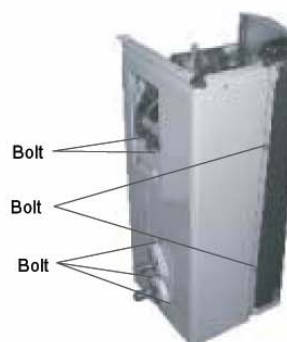

## Operation procedures/pictures

### Disassemble the front panel sub-assy

To screw off 5pcs tapping screws which come from the front panel, valve support, chassis and side plate of the condenser, then can take out the front panel sub-assy.

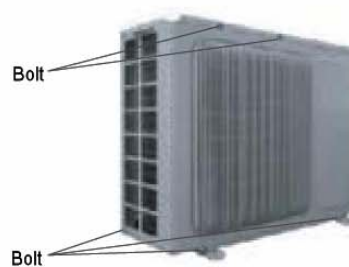

### Remove the electric appliance mounting board

To screw off 1pc bolt which fixed the electric appliance mounting board, take out the leading wire insert from the compressor and fan motor, take out the electric appliance mounting board.



### Disassemble the right side plate

To screw off 7pcs bolt of the rear side plate, then can disassemble the right side plate.

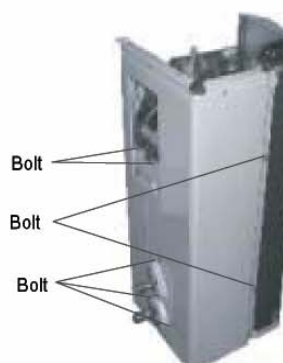

## Operation procedures/pictures

### Remove the axial flow fan

To loosen tighten nut with spanner (levorotation), take off the nut, spring washer, flat washer, and take out the axial flow fan forcibly.

Tighten nut

Axial flow fan

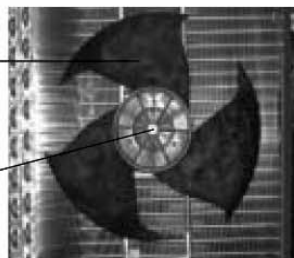

### Remove the motor, motor support

To screw off 4pcs tapping screw which fixed the motor, take out the motor. And screw off 2pcs tapping screw which fixed the motor support, lift it up, take out the motor support.

Motor support

Tapping screw

Motor

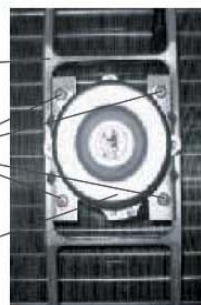

### Remove the 4-way valve (Only for heating only unit)

To screw off the tighten nut from the 4-way valve loops, then take out the loop, enwrap the 4-way vavie with wet cloth, unsolder 4pcs soldered point which connected with the 4-way valve, take out the 4-way valve.

The solder procedure should be as quick as possible, make sure that the guaze should keep wet, do not let the flame to damage the compressor lead wire.



Tighten screw

Solenoid coil



### Disassemble capillary

Unsolder the soldered point between capillary, valve and outlet pipe of condenser, can disassemble the capillary, when changing the capillary, do not let dregs block the capillary.



### Disassemble the gas valve and liquid valve

To screw off 2pcs bolt which fixed the gas valve, then unsolder the soldered point between the gas valve and air return connection pipe, take off the gas valve. (NOTE: When unsolder the soldered point, it is need to enwrap the gas valve with wet cloth, avoiding valve be damaged by high temp.)  
To screw off 2pcs bolt which fixed the liquid valve, then unsolder the soldered point between the liquid valve and forked pipe, take off the liquid valve.

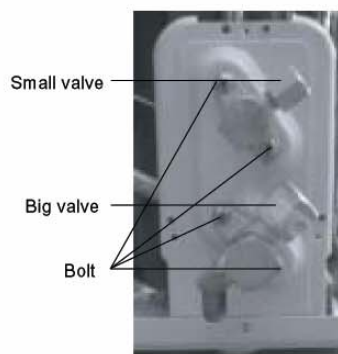

 **Disassemble the compressor**

Loosen 3pcs nut with washer at the compressor button;

(NOTE: It's need to discharge the refrigerant first.)

Unsolder the soldered points of air in pipe and air out pipe,  
remove the pipeline carefully, take out the compressor.

Cooling only unit

Cooling and heating unit

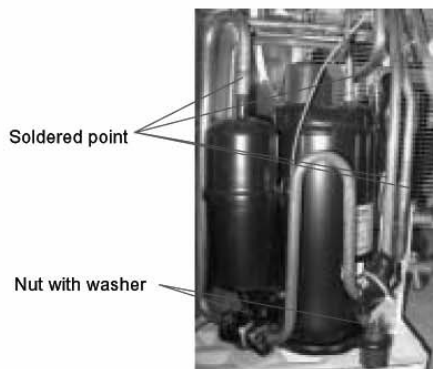
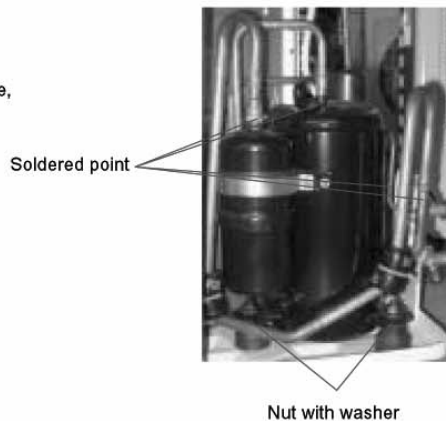

## EXPLODED VIEW – Indoor Unit

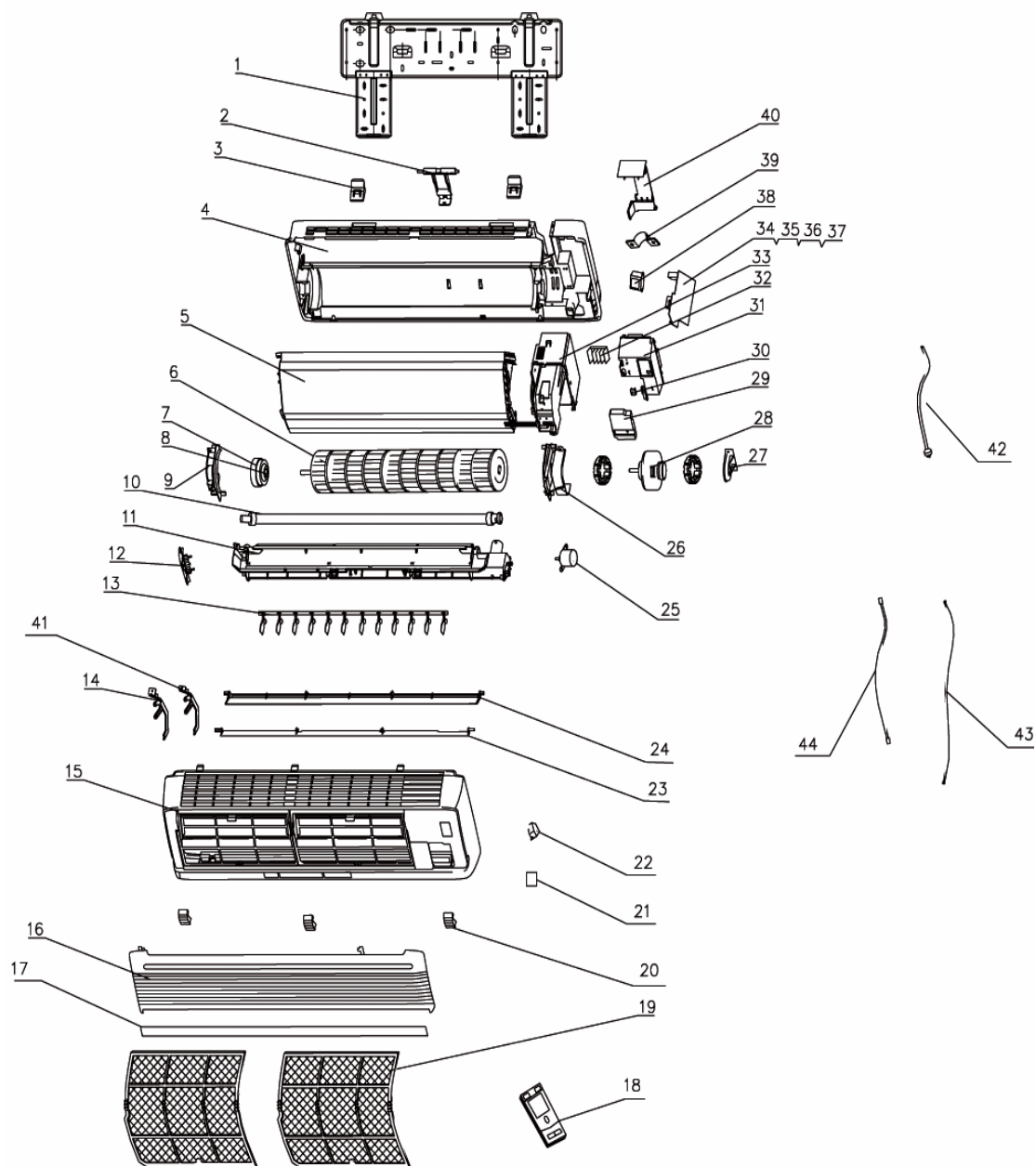

## PART LIST – Indoor Unit

No.	Description	Part No.		
		AC-S19CGA	AC-S19HGA	Qty
1	Wall Mounting Frame	01252384	01252384	1
2	Pipe Clamp	26112425	26112425	1
3	Hook	26272421	26272421	2
4	Rear Case	22202021	22202021	1
5	Evaporator Assy	01002017	01002017	1
6	Cross Flow Fan Assy	10352405	10352405	1
7	Bearing Holder	76712015	76712015	1
8	Fan Bearing	76512210	76512210	1
9	Left Clamp of Motor	261124281	261124281	1
10	Drainage Pipe	05232411	05232411	1
11	Water Tray	20182439	20182444	1
12	Stepping Motor Gear	10592001	10592001	1
13	Round Hole Blade	10512429	10512429	10
	Quadrate Hole Blade	10512430	10512430	2
	Swing Connecting Rod	10582439	10582439	1
14	Guide Louver Holder	24212429	24212429	1
15	Front Case	20002613	20002613	1
16	Front Panel	AC-S19CGA	AC-S19HGA	1
17	Decoration Purred	68012004	68012004	1
18	Wireless Remote Control	30515002	30515002	1
19	Filter	11122440	11122440	2
20	Screw Cover	24252440	24252440	3
21	Supporter	24212013	24212013	1
22	Receiving Board JD	30046042	30046042	1
23	Small Guide Louver	10512428	10512428	1
24	Big Guide Louver	10512427	10512427	1
25	Stepping Motor MP24GA	15212102	15212102	1
26	Right Clamp of Motor	26112429	26112429	1
27	Bearing Holder	26152423	26152423	1
28	Motor FN 22A	15012062	15012062	1
29	Top Cover of Electric box	22242017	22242017	1
30	Light Touch Switch	45010007	45010007	1
31	Cover Plate of Electric box	20102123	20102120	1
32	Terminal Board	42011138	42011138	1
33	Electric Box	20102108	20102108	1
34	Main Board	30035358	30035357	1
35	Tube Sensor	39000058	39000058	1
36	Room Sensor	39000045	39000045	1
37	Fuse	46010013	46010013	1
38	Power Transformer SC28B1	43110170	43110170	1
39	Wire Clamp (Mid)	71010103	71010103	1
40	Rear Clamp	26112430	26112430	1

41	Guide Louver Holder	24212429	24212429	1
42	Power Cable	40020389	40020389	1
43	Power Connecting Cable	40020440	40020440	1
44	Signal Control	/	40030325	1
45	Sensor Insert B	42020063	42020063	1
<b>The data are subject to change without prior notice</b>				

### Explosive view and spare parts list of outdoor unit

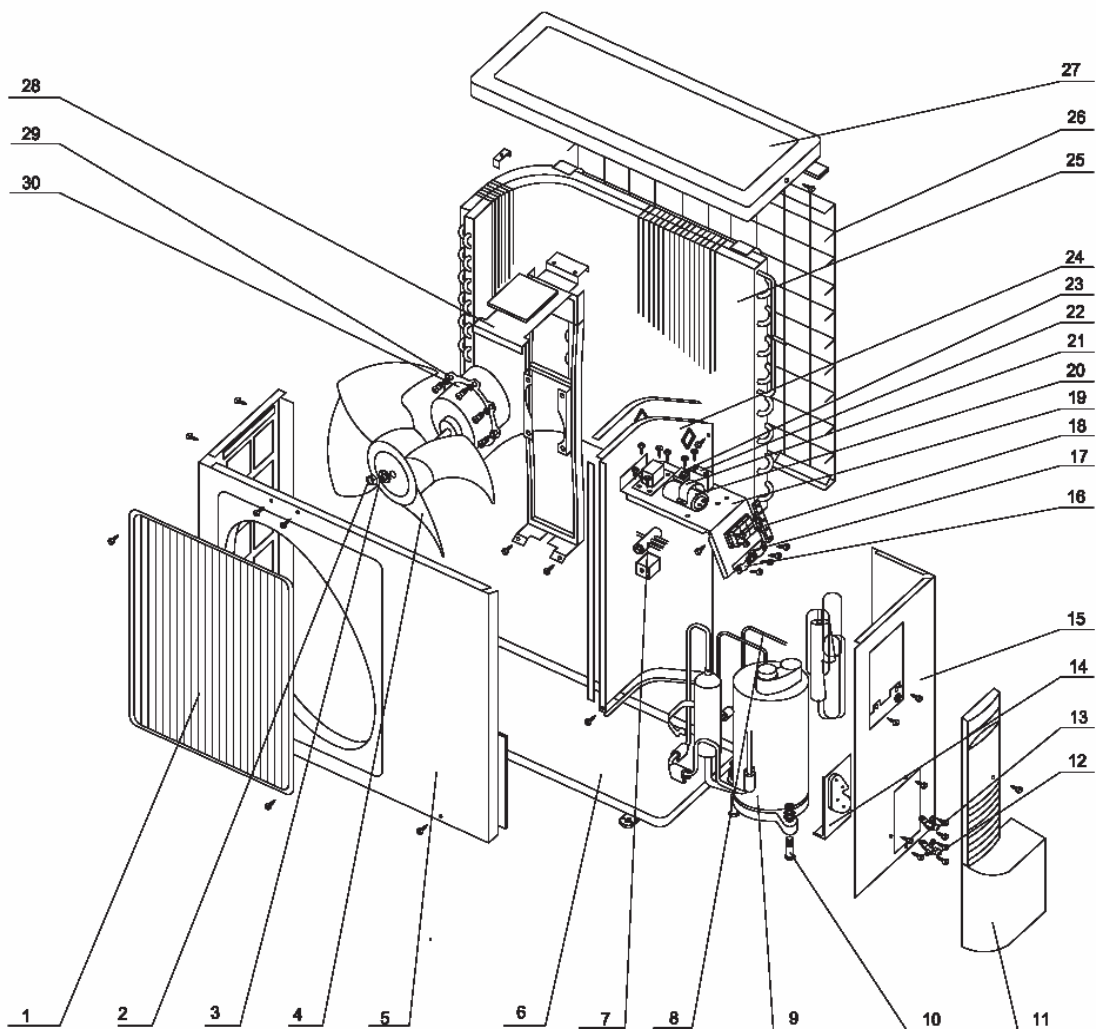

## PART LIST – Outdoor Unit

No.	Description	Part No.		
		AC-S19CGA	AC-S19HGA	Qty
1	Front Grill	22413431	22413431	1
2	Nut M6	70310132	70310132	1
3	Shim 6	70410252	70410252	2
4	Axial Flow fan	10333412	10333412	1
5	Front Panel	01533012	01533012	1
6	Chassis Sub-Assy	0123144	0123144	1
7	4-Ways Valve	/	/	/
8	Capillary Sub-Assy	03003216	03003215	1
9	Compressor and Fitting C-RV232BH1AA	0010135	0010135	1
10	Nut with Washer M8	70310014	70310014	3
11	Big handle Sub-Assy	26233433	26233433	1
12	Valve ½”	07100147	07100147	1
13	Valve ¼”	07100120	07100120	1
14	Valve Support	01713041	01713041	1
15	Right Side Plate Sub-Assy	01302004	01302004	1
16	Wire Clamp	71010103	71010103	2
17	Insulation Gasket	70410525	70410523	1
18	3 ways Terminal Board	42011241	42011113	1
19	Electric Box	0143425	0143425	1
20	Capacity (50µF / 440V )	33000001	33000001	1
21	Capacitor Clamp	02143401	02143401	1
22	Capacitor (3µF / 450VAC)	33010027	33010027	1
23	Terminal Board 2 – 8	/	/	/
24	Isolation Sheet Sub-Assy	01233417	01233417	1
25	Condenser Sub-Assy	011031861	01103185	1
26	Rear Grill	01473030	01473030	1
27	Top Cover Sub-Assy	012532611	012532611	1
28	Motor Support	01703391	01703391	1
29	Tapping Screw ST 4.8 x 16	70140165	70140165	4
30	Motor (FW48C)	15012039	15012039	1
31	Over Load Protector	Built-in	Built-in	1
32	Compressor Pad	76710202	76710202	3
<b>The data are subject to change without notice</b>				

## GUIDE FOR INSTALLATION

### Guide for installation

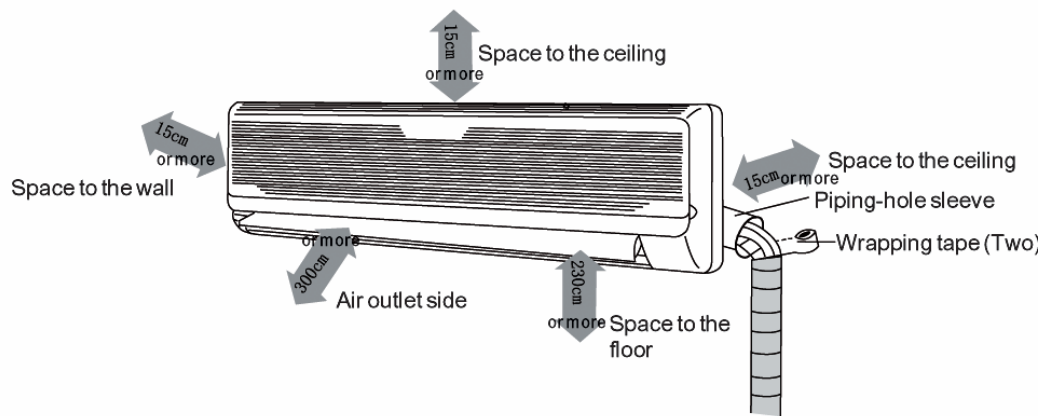

### Important Notes

- ★ The installation must be done by trained and qualified service personnel with reliability according to this manual.
- ★ Contact service center of GREE before installation to avoid the malfunction due to unprofessional installation.
- ★ When picking up and moving the units, you must be guided by trained and qualified personnel.
- ★ The distance between the air outlet vent and heat source, or inflammables should be more than 50cm.

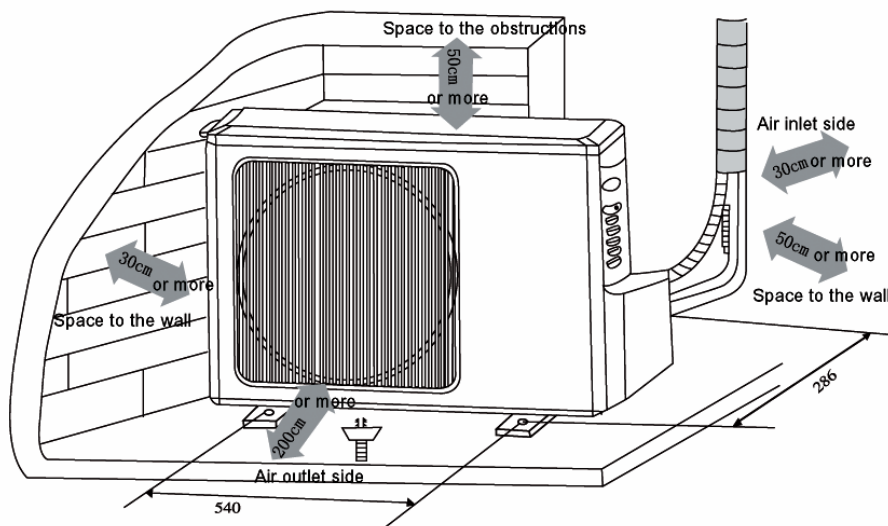



## Selection of installation location

### 1 Indoor unit

- The inlet and outlet should be far away from the obstructions so that the outflow air can reach all parts of the room;
- Install in a location connect with the outdoor unit easily;
- Install in a location from which the condensation water can be drained out conveniently;
- Avoid a location where there is heat source, steam or inflammable gas;
- Install in a location where is strong enough to withstand the full weight and vibration of the unit;
- Be sure that the installation conforms to the installation dimension diagram;
- Be sure to leave enough space to allow access for routine maintenance, the height between the indoor unit and outdoor unit should be more than 200cm;
- Select a place about 1 meter away from the TV set or any other electric appliances;
- The place where the air filter can be easily taken out.
- Avoid to use the unit in the places near the laundry, bathroom, or swimming pool.

### 2 Outdoor unit

- Select a place from which noise and outflow air emitted by unit will not inconvenience neighbors.
- Select a location where there should be sufficient ventilation.
- There are should be no obstructions block the air inlet and air outlet vents near the outdoor unit.
- The location should be able to withstand the full weight and vibration of the outdoor unit and permit safe installation.
- There should be no danger of flammable gas or corrosive gas leaks.
- Be sure that the installation conforms to the installation dimension diagram.

### NOTE:

Install in the following place may cause malfunction. If it is unavoidable, contact the dealer please.

- The place where oil (machine oil) is used.
- The place where a lot of salinities such as coast exists.
- The place where a sulfured gas such as the hot spring zones is generated.
- The palce where high-frequency waves are generated by radio equipment, welders and medical equipment.
- Other place with special circumstance.



## Install the indoor unit

### 1 Install the wall mounting plate

- Measure horizon by handling line or horizontal measurement. Since drainage pipe hole is on left side, when adjusting panel, the left should never be higher; it is better to make it lower.
- Fix the wall mounting plate on the selected location with screws.
- Pull the rear panel by hands after installation to see if it is firm enough. The rear panel should be able to stand the weight of an adult (60kg) and the weight should be evenly shared by each screw.

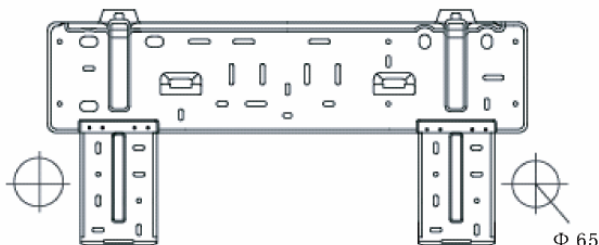

### 2 Install drainage hose

- Drainage hose must be placed at a downward slant for smooth drainage.
- Do not wrench, bend or heave the hose or flood its end by water.

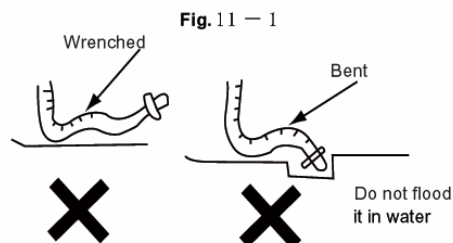

### 3 Open piping hole

- Drill a hole outward at a slant after accertaining location piping hole as in fig.11-1.  $\Phi$  65
- In order to prevent pipe and cable from damaging when going through the hole, install wall sleeve.

### 4 Install connection pipe

- Connect the connection pipe with two leading pipes from indoor unit, and then tighten the joint nuts on connection pipe.

NOTE:

- Connect connection pipes with indoor unit first and then outdoor unit.
- Bend the connection pipe carefully or it would be damaged.
- Don't tighten the joint nut too much or leakage would occur.

### 5 Electric wiring

- Open front panel upwardly.
- Take off covering plate.
- To pull out the power conneting cable from the back of the indoor unit, and put it through the wire hole, then connect with the power cable.
- As shown in Fig.11-2, connect the blue wire of power connect wire onto terminal "N", red wire onto terminal "2", brown onto terminal "3" and yellow-green one (earth wire) to terminal "⊕"
- Recover the wire covering plate.
- Cover the front panel.
- For heat pump type unit, to fix the signal control cable on the chassis by using wire clamp.

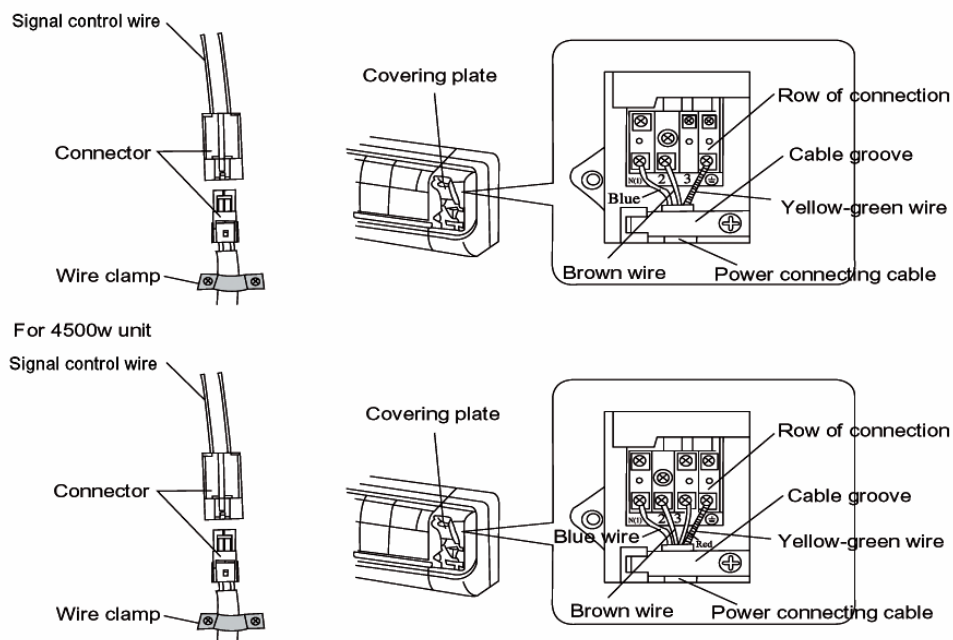

Fig.11-2

**NOTE:**

- All electric installation must be done by professional personnel according to local law, regulation and this manual.
- Power cable adopts Y type, if the power cable damaged, in order to avoid the danger, make sure to ask the manufacturer, after sales dealer or professional to replace.
- The power supply must adopt rated voltage and exclusive circuit for air conditioner.
- The creepage switch and air switch with suitable capacity must be installed, the 10A air switch is fit for the cooling capacity lower than 2500W unit (including 2500W), if the unit with cooling capacity higher than 2500W, the 16A air switch should be used.

**● Install indoor unit**

- When routing the pipe (wiring) from the left or right side, cut off the tailings of the left pipe on base of main unit. (as shown in Fig.11-3)

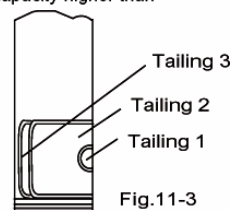

- ① Cut off tailing 1, tailing 2 only power cable is routed;
  - ② Cut off tailing 1, tailing 2 when connection pipe and power cord are routed;
- After wrapped piping and wiring, pull them through the piping hole; As shown in Fig.11-4
  - Put two claws which behind the indoor unit, to hang on the clamp of the wall mounting plate, and to move the unit left and right, to see it is firm or not.
  - Ensure that the install height of indoor unit is 2.3m or more.

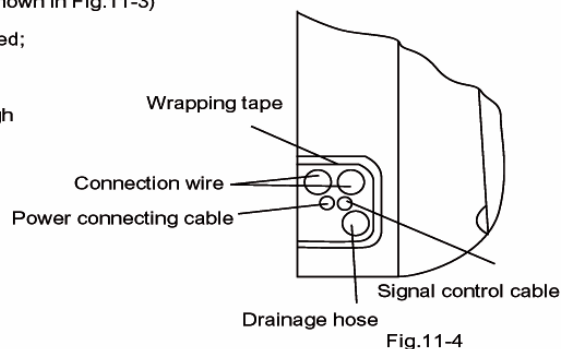

Fig.11-4

## Install outdoor unit

### 1) Install connection pipe

- Align the flare of connection pipe to the joint flare of corresponding valve.
- Tighten nuts on connection pipe forcibly then tighten it by spanner as shown in right figure.

NOTE: Too great of torque would damage nuts.

Refer the following list for tighten torque

Diameter of nut (mm)	Torque wrench (N·m)
Φ6	15~20
Φ9.5	31~35
Φ12	50~55

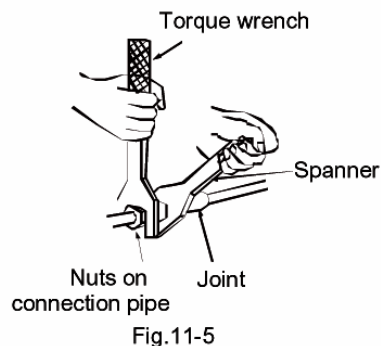

Fig.11-5

### 2) Wiring connection

- Disassemble the handle on the right side plate of the outdoor unit. (one screw)
- Disassemble the wire clamp, connect the power connecting cable onto the terminal and fix well. The wiring layout should be accord with indoor unit, to cut off the tailing of wire hole on the right side plate, then to put on the loop.
- To fix the power connecting cable with wire clamp, for cooling and heating unit, need to fix the signal control cable with wire clamp, then connect the corresponding connector.
- Make sure that the wiring are fixed well or not.
- Install the handle. ( fixed by one screw)

The synop for terminal connection

Terminal	Wire
N(1)	Blue
2	Brown
3	Red
⊕	Yellow-green

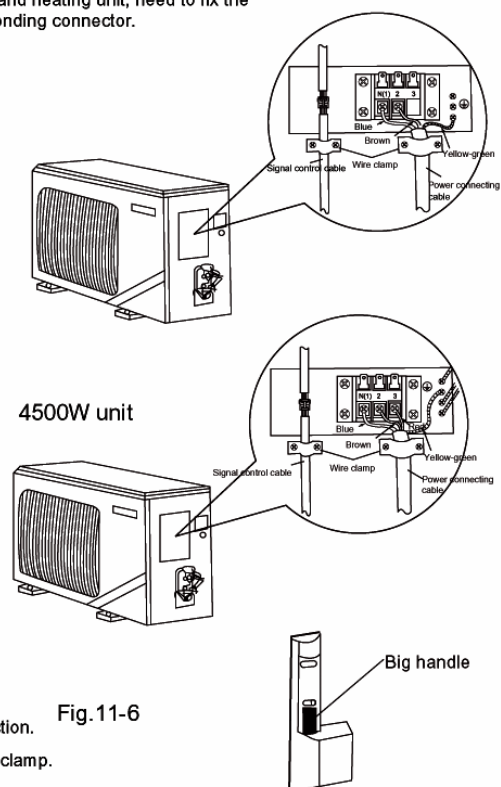

Fig.11-6

#### NOTE:

- Wrong wiring connection may cause electric appliance malfunction.
- Don't pull the electrical wire which had been fixed well by wire clamp.

### 3) Air purging and leakage test

- Remove the fluorine charging nozzle nuts cap on the gas valve.
- Align the center charging flexible tube which is on the vacuum gauge with the low(Lo)pressure port, then connect to the fluorine charging nozzle. (As shown in Fig.11-8)
- Start up the vacuum pump, when the hand pointed 1 bar, to close the low pressure (Lo) handle tightly, and stop the vacuumizing. And keep more than 15 minutes, make sure that the pressure of vacuum gauge is unchanged.
- Remove the valve caps of the gas valve and liquid valve.
- Slightly to loose the liquid valve stem with hex wrench, until the pressure of vacuum pump rise up to 0 bar above.
- Unhitch the charging pipe away from the fluorine charging nozzle, and tighten the nut cap of the charging nozzle.
- Open the valve stem of liquid valve and gas valve, with hex wrench.
- Tighten the valve caps of gas valve and liquid valve, and check the air leakage.

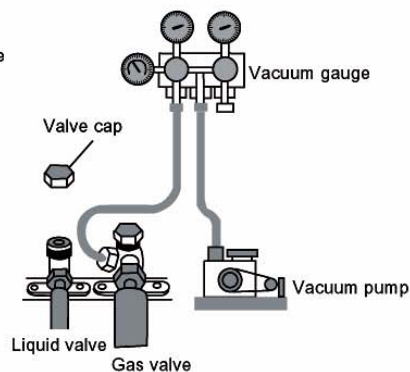

Fig.11 - 7

### 4) Outdoor condensation drainage (Heat pump type only)

- When the unit is heating, the condensing water and defrosting water formed in the outdoor unit can be drained out reliably through the drain hose.

#### Installation method:

Install the outdoor drain elbow in the hole on  $\phi 25$  hole on the base plate as shown in right figure, and joint the drain hose to the elbow, so that the waste water formed in the outdoor unit can be drained out to a proper place.

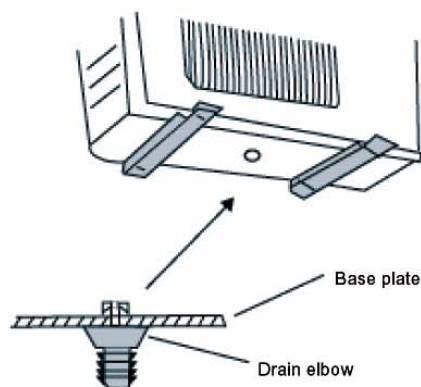

Fig.11-8

## Test operation and check after installation

### 1 Test operation

#### 1. Before test operation

- Do not switch on power before installation is finished completely.
- Electric wiring must be connected correctly and securely.
- Cut-off valves should be opened.
- All the impurities such as scraps and thums must be cleared from the unit.
- Open the front panel, set "Run" mode by the manual switch.

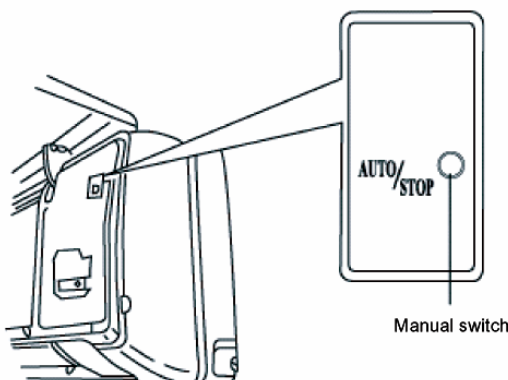





Fig. 11 - 9

#### 2. Test operation method

- Switch on power and press "1/0" button on the wireless remoter control.
- Press "MODE" button, select  ,  ,  , to observe whether the running is normal or not.
- Emergency operation

If the wireless remote control is lost, emergency running can be operated as follow:

- ( 1 ) To set "AUTO" mode by manual switch, unit will automatically to select mode according to the room temp.by microcomputer.
- ( 2 ) In the running mode, to set the manual switch to "STOP", unit will stop running.

### 2 Check after installation

Items to be checked	Possible malfunction	Remarks
Has it been fixed firmly?	The unit may drop, shake or emit noise.	
Have you done the refrigerant leakage test?	It may cause insufficient refrigeration capacity.	
Is heat insulation sufficient?	It may cause condensation and dripping.	
Does the unit drain well?	It may cause condensation and dripping.	
Is the voltage in accordance with the rated voltage marked on the nameplate?	It may cause electric malfunction or damage the part.	
Is the electrical wiring and piping connection installed correctly and securely?	It may cause electric malfunction or damage the part.	
Has the unit been connected to a secure earth connection?	It may cause electrical leakage	
Is the power cord specified?	It may cause electric malfunction or damage the part.	
Has the inlet and outlet been covered?	It may cause insufficient refrigerating capacity.	
Has the length of connection pipes and the refrigerant charge been recorded?	The refrigerant capacity is not accurate.	



## CARE & MAINTENANCE

### Warning

- Turn power off and pull out the power plug before cleaning air conditioner. Or it may cause the electric shock.
- Never dampen the air conditioner, it can cause the electric shock. And never sprinkle water on the unit.
- Volatile liquid (e.g. thinner or gasoline) will damage the air conditioner. (So wipe the units with a dry soft cloth, or a cloth slightly moistened with water or cleanser.)



### Clean the surface panel

#### 1 Take down the front panel

Along the direction of arrows to pull of the front pannel an angle from the slots of the front pannel,then pull down the air filter and take it out.

#### 2 Clean the front panel

Use a soft brush with little water and detergent to clean, then to dry it in the shade.

#### 3 To install the front panel

To insert the supports of both sides into the supports' slot, and put the middle axis into the groove, then along the arrow direction to recover the front panel cover and clasp it.

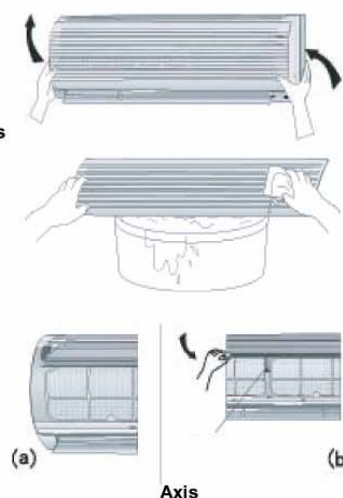

### Clean the filter

#### 1 Take down the filter

Along the direction of arrows to pull of the front pannel an angle from the slots of the front pannel,then pull down the air filter and take it out, as shown in the right Fig.

#### 2 Cleaning

To clear the dust adhering to the filters, you can either use a dust collector, or wash them with warm water(the water with the neutral detergent should below 45°C) when the filters are very dirty(such as oil stain),and dry it in the shadow. As shown in the right Fig.

#### 3 Reinsert the filter

Reinsert the filters with side marked , pay attention to the front side, then to clasp the front panel cover.

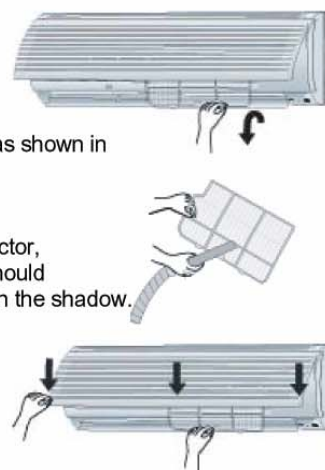

#### NOTE:

- Never to put the front panel or filter directly under the sun.
- Never use water above 45°C to wash the filters, or it could cause deformation or discoloration.
- Never parch it by fire, or it could cause a fire or deformation.

## MULFUNCTION ANALYSIS

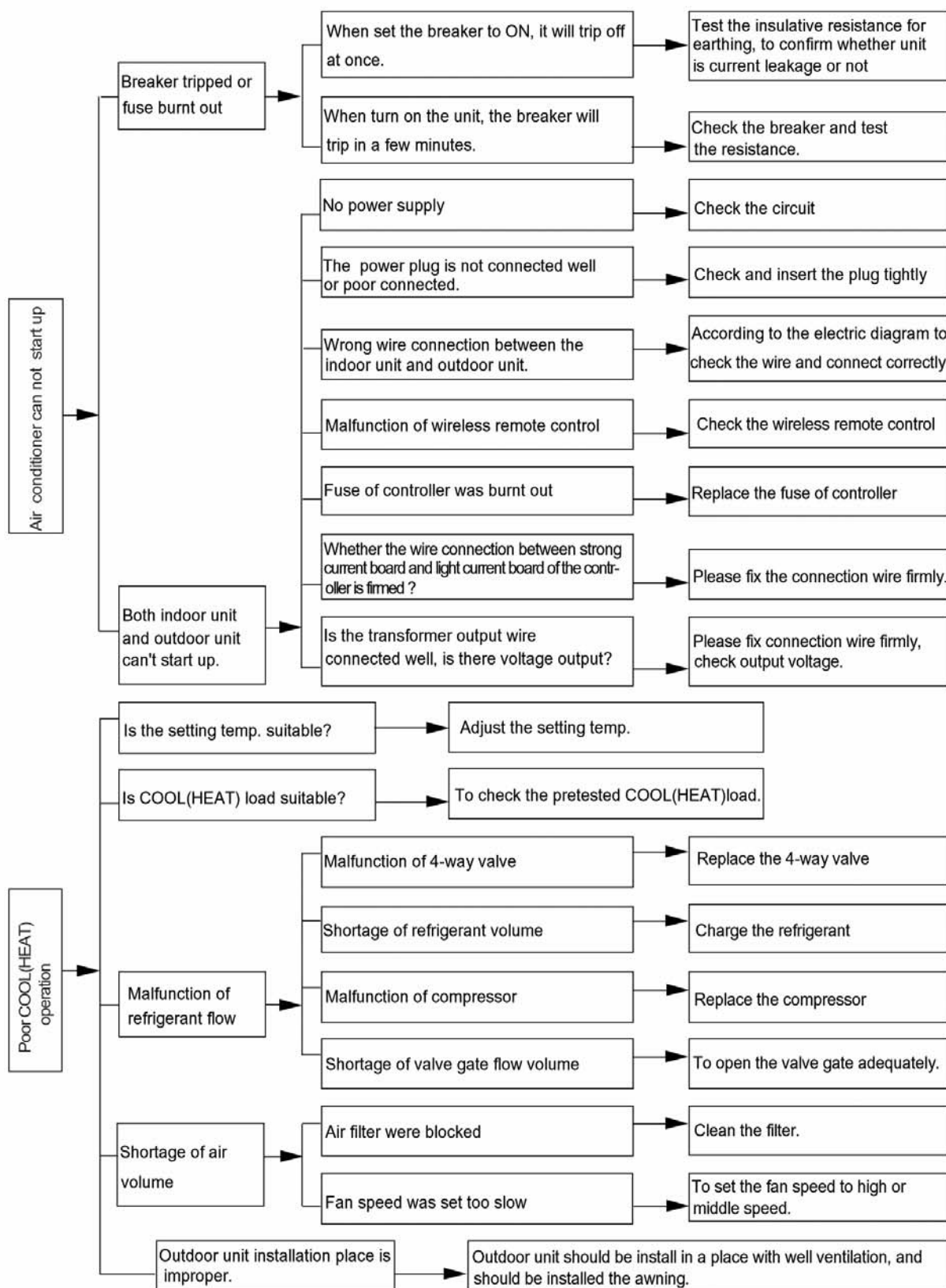



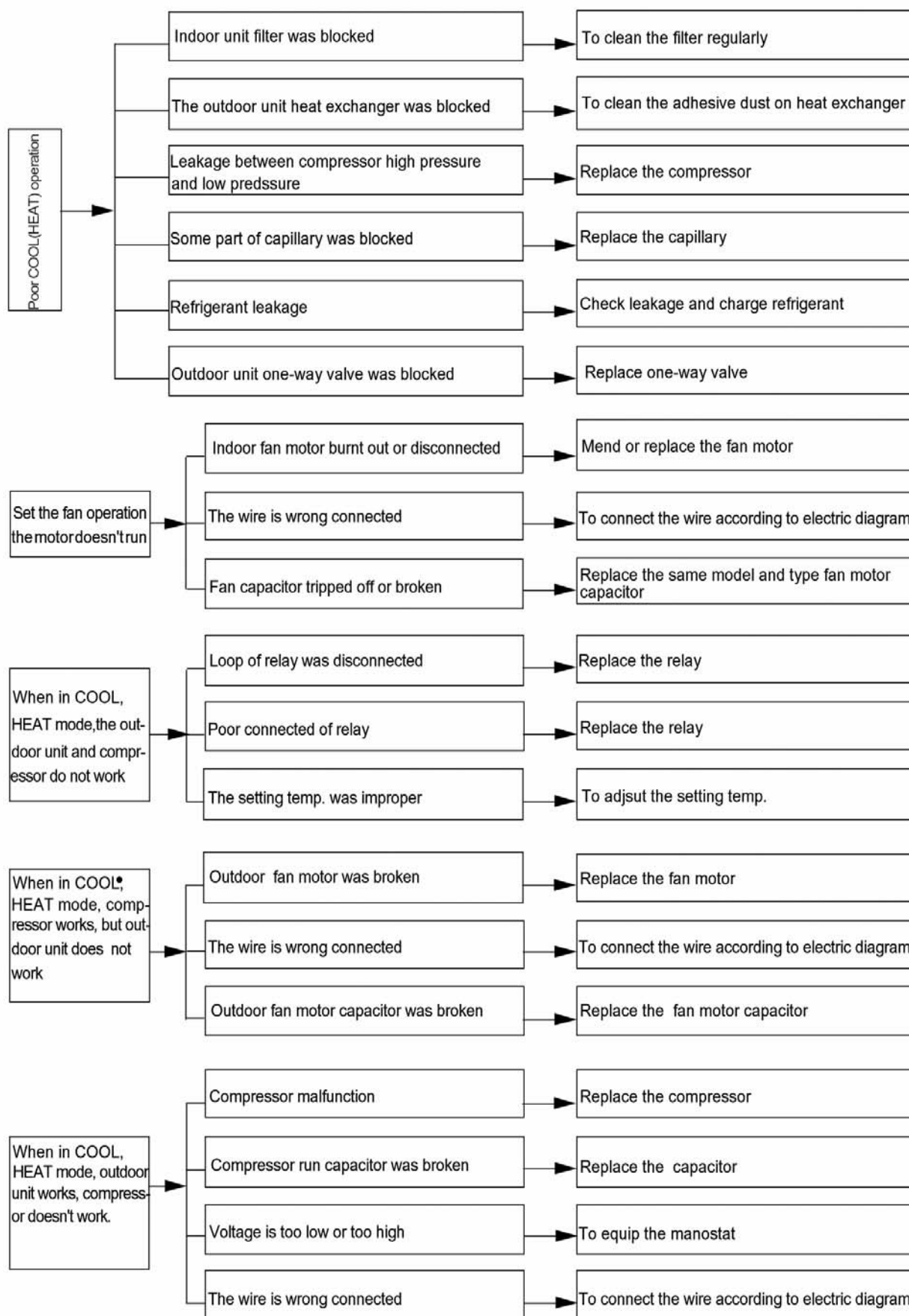

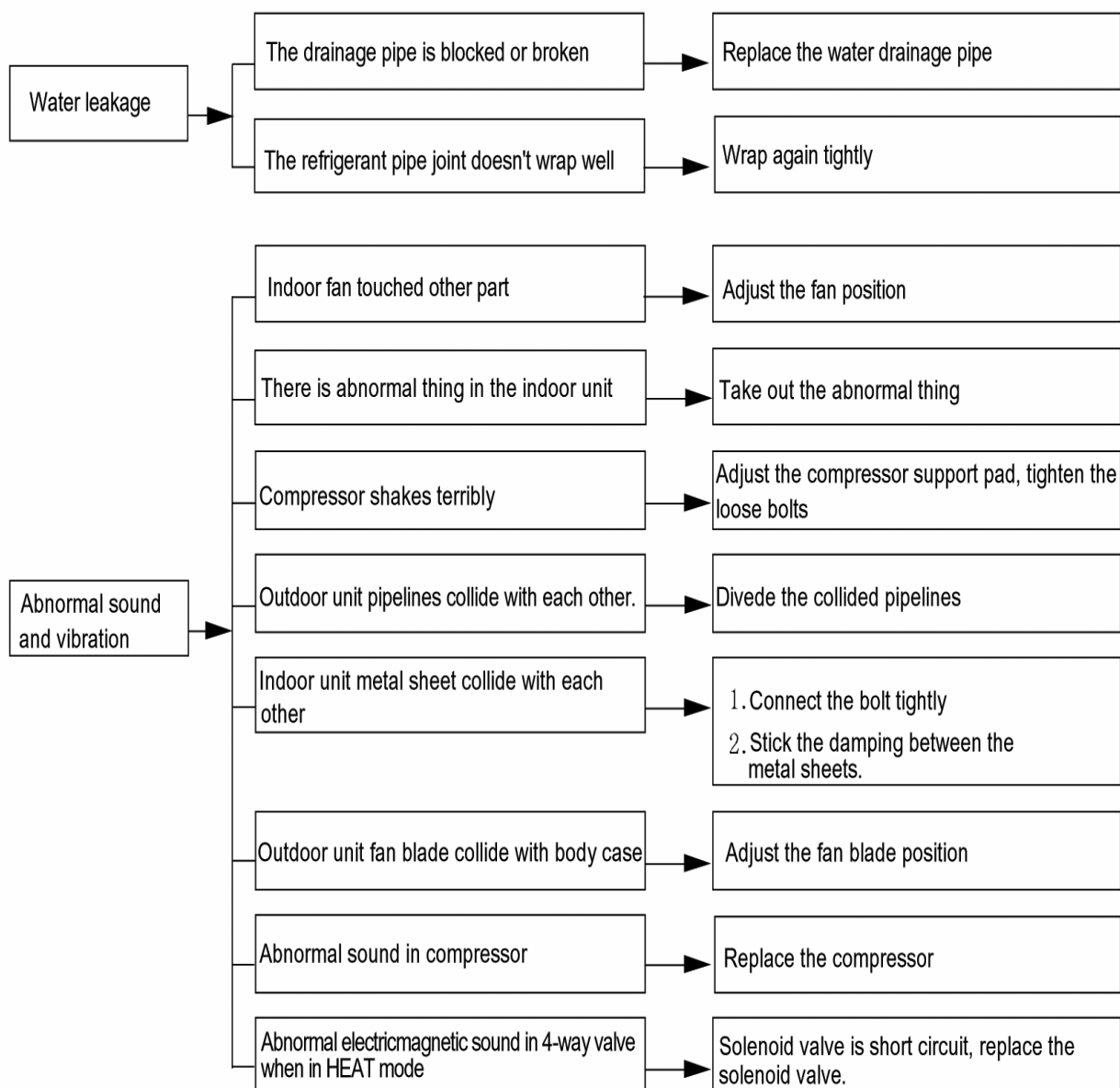



**Большая библиотека технической документации**  
<https://splitsystema48.ru/instrukcii-po-ekspluatacii-kondicionerov.html>  
**каталоги, инструкции, сервисные мануалы, схемы.**